

# BALL SOCKETS

**BALL SOCKETS** - Socket pressure-formed of seamless tubing. Use Low-Hydrogen Type 616 or Ni-Rod Nickel Welding Rod.  
 \*Starred Sockets have shoulders machined on side of ball.

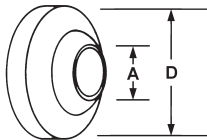
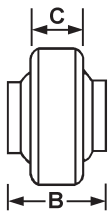
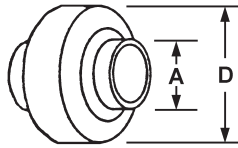

| Speeco Plated Part Number                         | A Pin Hole Diam. Inches | B Length Thru Bore Inches | C Greatest Sleeve Width Inches | D Sleeve Overall Diam. Inches | Price Per Piece | Danhusier Unplated Part Number | A Pin Hole Diam. Inches | B Length Thru Bore Inches | C Greatest Sleeve Width Inches | D Sleeve Overall Diam. Inches | Price Per Piece | Pkg. Qty. |
|---|-------------------------|---------------------------|--------------------------------|-------------------------------|-----------------|--------------------------------|-------------------------|---------------------------|--------------------------------|-------------------------------|-----------------|-----------|
| <b>5/8" Lift Arm Ball Sockets - Category 0</b>    |                         |                           |                                |                               |                 |                                |                         |                           |                                |                               |                 |           |
| B2225   | 5/8                     | 1                         | 3/4                            | 2                             | \$7.59          | 5870                           | 5/8                     | 1                         | 3/8                            | 2                             | \$6.11          | 4         |
| <b>7/8" Lift Arm Ball Sockets - Category 1</b>    |                         |                           |                                |                               |                 |                                |                         |                           |                                |                               |                 |           |
| ---   | 7/8                     | --                        | --                             | 2-1/4                         | ....            | 5088                           | 7/8                     | 1-3/8                     | 9/16                           | 2-1/4                         | 9.40            | 4         |
| B223  | 7/8                     | 1-3/8                     | 7/8                            | 2-3/8                         | 12.08           | ---                            | 7/8                     | --                        | --                             | 2-3/8                         | ....            | 4         |
| ---   | 7/8                     | --                        | --                             | 2-1/2                         | ....            | 5827                           | 7/8                     | 1-3/8                     | 3/8                            | 2-1/2                         | 12.11           | 4         |
| <b>1-1/8" Lift Arm Ball Sockets - Category 2</b>  |                         |                           |                                |                               |                 |                                |                         |                           |                                |                               |                 |           |
| B224 Reg.   | 1-1/8                   | 1-5/16                    | 7/8                            | 2-3/8                         | 13.11           | ---                            | 1-1/8                   | --                        | --                             | 2-3/8                         | ....            | 4         |
| B2216 Hvy.  | 1-1/8                   | 1-3/4                     | 1-3/8                          | 3-1/8                         | 20.24           | 5859                           | 1-1/8                   | 1-3/8                     | 3/8                            | 3-1/8                         | 17.08           | 4         |
| ---   | 1-1/8                   | --                        | --                             | 3-1/8                         | ....            | 5836                           | 1-1/8                   | 1-3/4                     | 9/16                           | 3-1/8                         | 19.91           | 4         |
| <b>1-7/16" Lift Arm Ball Sockets - Category 0</b> |                         |                           |                                |                               |                 |                                |                         |                           |                                |                               |                 |           |
| B2231   | 1-7/16                  | 1-3/4                     | 1-11/32                        | 3-1/2                         | 26.88           | 5865                           | 1-7/16                  | 1-3/4                     | 1/2                            | 3-1/2                         | 33.77           | 4         |
| <b>5/8" Top Link Ball Sockets - Category 1</b>    |                         |                           |                                |                               |                 |                                |                         |                           |                                |                               |                 |           |
| B2225   | 5/8                     | 1                         | 3/4                            | 2                             | 7.59            | 5870                           | 5/8                     | 1                         | 3/8                            | 2                             | 6.11            | 4         |
| <b>3/4" Top Link Ball Sockets - Category 1</b>    |                         |                           |                                |                               |                 |                                |                         |                           |                                |                               |                 |           |
| B216* Reg.  | 3/4                     | 1-5/8                     | 3/4                            | 2                             | 9.30            | 5868                           | 3/4                     | 1                         | 3/8                            | 2                             | 6.11            | 4         |
| ---   | 3/4                     | --                        | --                             | 2                             | ....            | 5500                           | 3/4                     | 1-3/4                     | 3/8                            | 2                             | 9.55            | 4         |
| B215* Hvy.  | 3/4                     | 1-5/8                     | 7/8                            | 2-1/8                         | 10.42           | ---                            | 3/4                     | --                        | --                             | 2-1/8                         | ....            | 4         |
| ---   | 3/4                     | --                        | --                             | 2-1/4                         | ....            | 5347                           | 3/4                     | 1-3/8                     | 9/16                           | 2-1/4                         | 9.40            | 4         |
| ---   | 3/4                     | --                        | --                             | 2-1/2                         | ....            | 5860                           | 3/4                     | 1-3/8                     | 3/8                            | 2-1/2                         | 12.11           | 4         |
| <b>1" Top Link Ball Sockets - Category 2</b>      |                         |                           |                                |                               |                 |                                |                         |                           |                                |                               |                 |           |
| ---   | 1                       | --                        | --                             | 2                             | ....            | 7466                           | 1                       | 1                         | 3/8                            | 2                             | 6.11            | 4         |
| B214* Reg.  | 1                       | 1-3/4                     | 7/8                            | 2-3/8                         | 12.05           | ---                            | 1                       | --                        | --                             | 2-3/8                         | ....            | 4         |
| ---   | 1                       | --                        | --                             | 2-3/4                         | ....            | 5526                           | 1                       | 1-3/4                     | 7/8                            | 2-3/4                         | 15.13           | 4         |
| ---   | 1                       | --                        | --                             | 3-1/8                         | ....            | 5849                           | 1                       | 1-3/4                     | 9/16                           | 3-1/8                         | 19.91           | 4         |
| <b>1-1/4" Top Link Ball Sockets - Category 3</b>  |                         |                           |                                |                               |                 |                                |                         |                           |                                |                               |                 |           |
| ---   | 1-1/4                   | --                        | --                             | 2-3/4                         | ....            | 5924                           | 1-1/4                   | 1-3/4                     | 7/8                            | 2-3/4                         | 15.09           | 4         |
| B2229   | 1-1/4                   | 1-3/4                     | 1-9/32                         | 3-1/8                         | 20.24           | 5925                           | 1-1/4                   | 1-3/4                     | 9/16                           | 3-1/8                         | 25.22           | 4         |
| <b>1-3/4" Top Link Ball Sockets - Extra Large</b> |                         |                           |                                |                               |                 |                                |                         |                           |                                |                               |                 |           |
| ---   | 1-3/4                   | --                        | --                             | 4-1/2                         | ....            | 5910                           | 1-3/4                   | 2-1/2                     | 1                              | 4-1/2                         | 105.46          | 4         |

## REPLACEMENT BALLS -

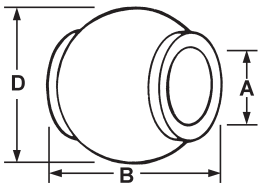

| Speeco Part Number                       | Type   | A Pin Diam. Inches | B Length Thru Bore Inches | D Sleeve Overall Diam. Inches | Price Per Piece | Pkg. Qty. | Speeco Part Number                     | Type  | A Pin Diam. Inches | B Length Thru Bore Inches | D Sleeve Overall Diam. Inches | Price Per Piece | Pkg. Qty. |
|--|--------|--------------------|---------------------------|-------------------------------|-----------------|-----------|--|-------|--------------------|---------------------------|-------------------------------|-----------------|-----------|
| <b>7/8" Lift Arm Ball - Category 1</b>   |        |                    |                           |                               |                 |           | <b>3/4" Top Link Ball - Category 1</b> |       |                    |                           |                               |                 |           |
| B243                                     | Ford   | 7/8                | 1-3/8                     | 2-1/4                         | \$6.91          | 4         | B241                                   | Deere | 3/4                | 1-3/4                     | 2                             | \$7.05          | 4         |
| <b>1-1/8" Lift Arm Ball - Category 2</b> |        |                    |                           |                               |                 |           | <b>1" Top Link Ball - Category 2</b>   |       |                    |                           |                               |                 |           |
| B246                                     | Oliver | 1-1/8              | 1-3/4                     | 2                             | 7.05            | 4         | B242                                   | Deere | 1                  | 1-3/4                     | 2                             | 7.05            | 4         |
| B244                                     | Ford   | 1-1/8              | 1-3/4                     | 2-1/4                         | 7.51            | 4         |  |       |                    |                           |                               |                 |           |

**SPEECO COMBINATION BALL SOCKETS** - Di-Chrome Plated - Use Low Hydrogen, Type 616 or Ni-Rod Nickel Welding Rod.  
 Keep one ball socket in stock for both pin hole sizes. Socket pressure formed of seamless tubing.



| Plated Part No.  | Replaces Unplated Part Number | Sleeve Overall Diam. Inches | Sleeve Width Inches | Length Thru Bore Inches | Price Per Piece | Pkg. Qty. | Plated Part No.  | Unplated Part Number | Sleeve Overall Diam. Inches | Sleeve Width Inches | Length Thru Bore Inches | Price Per Piece | Pkg. Qty. |
|--|-------------------------------|-----------------------------|---------------------|-------------------------|-----------------|-----------|--|----------------------|-----------------------------|---------------------|-------------------------|-----------------|-----------|
| <b>7/8" and 1-1/8" Pin Hole Diameter Lift Arm Ball Sockets - Category 1 or 2</b> |                               |                             |                     |                         |                 |           | <b>3/4" and 1" Pin Hole Diameter Top Link Ball Sockets - Category 1 or 2</b> |                      |                             |                     |                         |                 |           |
| B232   | B231                          | 2-3/4                       | 1-3/16              | 1-3/4                   | \$20.48         | 4         | B236   | B235                 | 2-3/8                       | 7/8                 | 1-1/2                   | \$14.31         | 4         |

**ASK FOR QUANTITY DISCOUNT** Prices subject to change without notice.

# THREE POINT LINKAGE PARTS

## ADJUSTABLE & FORGED DRAW PINS & BUSHINGS

**C3**

### SPEECO ADJUSTABLE PLATED DRAW PINS

For 3-Point Hook-Up Tools  
Shoulder adjusts to various  
stabilizer arm spacings.  
Cold rolled steel.  
Di-chromate plated.

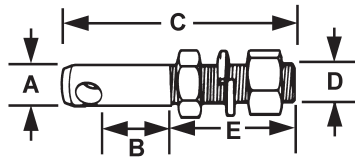

| Part Number  | A<br>Pin<br>Diam.<br>Inches | B<br>Useable<br>Length<br>Inches | C<br>Length<br>Overall<br>Inches | D<br>Thread<br>Diam.<br>Inches | E<br>Useable<br>Thread<br>Length | Price<br>Per<br>Piece | Pkg.<br>Qty. |
|--|-----------------------------|----------------------------------|----------------------------------|--------------------------------|----------------------------------|-----------------------|--------------|
| <b>Category 0 with Washer and 2 Nuts - Adjustable Regular Type</b>       |                             |                                  |                                  |                                |                                  |                       |              |
| <b>P7220</b>   | 5/8                         | 1-5/16                           | 3-7/8                            | 5/8                            | 2                                | <b>\$2.88</b>         | 4            |
| <b>Category 1 with Washer and 2 Nuts - Adjustable Regular Type</b>       |                             |                                  |                                  |                                |                                  |                       |              |
| <b>P722</b>  | 7/8                         | 1-5/8                            | 5                                | 7/8                            | 2-5/8                            | <b>3.45</b>           | 4            |
| <b>LA-1*</b>   | 7/8 Long                    | 1-3/4                            | 5-1/4                            | 7/8                            | --                               | <b>7.77</b>           | 4            |
| <b>Category 2 with Washer and 2 Nuts - Adjustable Regular Type</b>       |                             |                                  |                                  |                                |                                  |                       |              |
| <b>P721</b>  | 1-1/8                       | 1-3/4                            | 6-1/8                            | 1-1/8                          | 3-5/8                            | <b>9.30</b>           | 4            |
| <b>LA-2*</b>   | 1-1/8 Long                  | 1-15/16                          | 6-1/4                            | 1-1/8                          | --                               | <b>14.06</b>          | 4            |
| <b>Category 0 to 1 with Washer and 2 Nuts - Adjustable Reducing Type</b> |                             |                                  |                                  |                                |                                  |                       |              |
| <b>P7221</b>   | 7/8                         | 1-3/4                            | 4-1/2                            | 5/8                            | 2                                | <b>5.22</b>           | 4            |
| <b>Category 1 to 2 with Washer and 2 Nuts - Adjustable Reducing Type</b> |                             |                                  |                                  |                                |                                  |                       |              |
| <b>P724</b>  | 1-1/8                       | 1-3/4                            | 5-1/4                            | 7/8                            | 2-7/16                           | <b>6.64</b>           | 4            |
| ---  | 1-1/8 Long                  | --                               | --                               | 7/8                            | --                               | ....                  | 4            |
| ---  | 1-1/8 Long                  | --                               | --                               | 7/8                            | --                               | ....                  | 4            |
| <b>Category 2 to 3 with Washer and 2 Nuts - Adjustable Reducing Type</b> |                             |                                  |                                  |                                |                                  |                       |              |
| <b>P7211</b>   | 1-7/16                      | 2                                | 6-1/2                            | 1-1/8                          | 3-3/8                            | <b>18.06</b>          | 4            |

\* Miller

### FORGED STEEL WITH SHOULDER

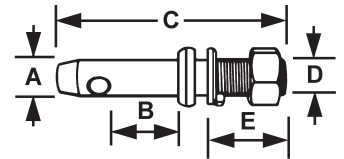

| Part Number  | A<br>Pin<br>Diam.<br>Inches | B<br>Useable<br>Length<br>Inches | C<br>Length<br>Overall<br>Inches | D<br>Thread<br>Diam.<br>Inches | E<br>Useable<br>Thread<br>Length | Price<br>Per<br>Piece | Pkg.<br>Qty. |
|--|-----------------------------|----------------------------------|----------------------------------|--------------------------------|----------------------------------|-----------------------|--------------|
| <b>Category 1 with Washer and 1 Nuts - Forged Steel Shoulder Type</b>      |                             |                                  |                                  |                                |                                  |                       |              |
| <b>P728</b>  | 7/8                         | 1-3/4                            | 5-1/2                            | 7/8                            | 1-5/8                            | <b>3.07</b>           | 4            |
| <b>P726</b>  | 7/8 Long                    | 1-3/4                            | 5-3/4                            | 7/8                            | 1-1/8                            | <b>12.00</b>          | 4            |
| <b>Category 2 with Washer and 1 Nuts - Forged Steel Shoulder Type</b>      |                             |                                  |                                  |                                |                                  |                       |              |
| <b>P7212</b>   | 1-1/8                       | 1-3/4                            | 6-1/8                            | 1-1/8                          | 2-3/8                            | <b>8.32</b>           | 4            |
| ---  | ---                         | ---                              | ---                              | ---                            | ---                              | ....                  | --           |
| <b>Category 0 to 1 with Washer and 1 Nuts - Forged Steel Reducing Type</b> |                             |                                  |                                  |                                |                                  |                       |              |
| <b>P7248</b>   | 7/8                         | 1-15/16                          | 4-1/2                            | 5/8                            | 5/8                              | <b>8.71</b>           | 4            |
| <b>Category 1 to 2 with Washer and 1 Nuts - Forged Steel Reducing Type</b> |                             |                                  |                                  |                                |                                  |                       |              |
| <b>P7240</b>   | 1-1/8                       | 1-13/16                          | 5-1/4                            | 7/8                            | 1-5/8                            | <b>6.31</b>           | 4            |
| <b>LA1-2*</b>  | 1-1/8 Long                  | ---                              | 5-1/4                            | 7/8                            | ---                              | <b>10.94</b>          | 4            |
| <b>P7246</b>   | 1-1/8 Long                  | 2-1/4                            | 6-5/16                           | 7/8                            | 2-1/4                            | <b>9.93</b>           | 4            |
| <b>Category 2 to 3 with Washer and 1 Nuts - Forged Steel Reducing Type</b> |                             |                                  |                                  |                                |                                  |                       |              |
| ---  | ---                         | ---                              | ---                              | ---                            | ---                              | ....                  | --           |

\* Miller

### BUSHINGS -

Made of seamless cold rolled tubing.  
Heat treated and di-chromate plated.



| Speeco Part Number                        | I.D.<br>Size<br>Inches | O.D.<br>Size<br>Inches | Length<br>Inches | Price<br>Per Piece | Qty.<br>Pkg. |
|---|------------------------|------------------------|------------------|--------------------|--------------|
| <b>Draw Pin Bushing - Category 1 to 0</b> |                        |                        |                  |                    |              |
| <b>B828</b>                               | 5/8                    | 7/8                    | 1-3/8            | <b>\$1.39</b>      | 4            |
| <b>Draw Pin Bushing - Category 1 to 2</b> |                        |                        |                  |                    |              |
| <b>B821</b>                               | 7/8                    | 1-1/8                  | 1-3/4            | <b>1.44</b>        | 4            |
| <b>AB1-2*</b>                             | 7/8                    | 1-1/8                  | 1-3/4            | <b>1.98</b>        | 4            |
| <b>Draw Pin Bushing - Category 2 to 3</b> |                        |                        |                  |                    |              |
| <b>B832</b>                               | 1-1/8                  | 1-7/16                 | 1-3/4            | <b>1.82</b>        | 4            |
| <b>B8312#</b>                             | 1-1/8                  | 1-7/16                 | 2-1/2            | <b>3.94</b>        | 4            |
| <b>Top Link Bushing - Category 0 to 1</b> |                        |                        |                  |                    |              |
| <b>B829</b>                               | 5/8                    | 3/4                    | 1-5/8            | <b>1.39</b>        | 4            |
| <b>Top Link Bushing - Category 1 to 2</b> |                        |                        |                  |                    |              |
| <b>B831</b>                               | 3/4                    | 1                      | 1-15/16          | <b>1.44</b>        | 4            |
| <b>Top Link Bushing - Category 2 to 3</b> |                        |                        |                  |                    |              |
| <b>B833</b>                               | 1                      | 1-1/4                  | 1-3/4            | <b>1.88</b>        | 4            |

\*Miller # With 15/32 Lynch Pin Hole

### STABILIZER STUB PINS -

Di-Chromate Plated



| Speeco Part Number | Pin<br>Diam.<br>Inches | Thread<br>Diam.<br>Inches | Length<br>Overall<br>Inches | Useable<br>Length<br>Inches | Price<br>Per<br>Piece | Pkg.<br>Qty. |
|--------------------|------------------------|---------------------------|-----------------------------|-----------------------------|-----------------------|--------------|
| <b>P781</b>        | 7/8                    | 5/8                       | 2-5/8                       | 3/8                         | <b>\$2.48</b>         | 4            |
| <b>P711</b>        | 7/8 Long               | 7/8                       | 3-1/4                       | 1/2                         | <b>4.11</b>           | 4            |

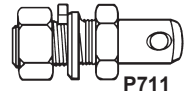

### CATEGORY III CLEVIS DRAW PIN -

Di-Chromate Plated, Drilled for 7/16" Lynch Pin.

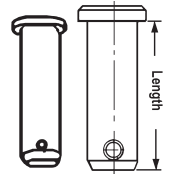

| Part Number  | Pin<br>Diam.<br>Inches | Wt.<br>Lbs. | Length<br>Overall<br>Inches | Useable<br>Length<br>Inches | Price<br>Per<br>Piece | Pkg.<br>Qty. |
|--------------|------------------------|-------------|-----------------------------|-----------------------------|-----------------------|--------------|
| <b>P7230</b> | 1-7/16                 | 3           | 6                           | 4-1/2                       | <b>\$11.94</b>        | 4            |
| <b>P7231</b> | 1-7/16                 | 3-1/2       | 7-3/4                       | 6-1/4                       | <b>13.09</b>          | 4            |

### DUAL CATEGORY DRAW PINS - Plated

Allows use of same implement with two categories of tractor without changing pin. Nut and lock washer included.

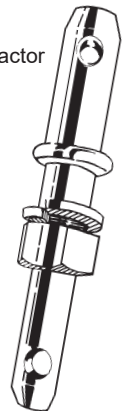

| Part Number  | Pin<br>Diam.<br>Inches | Wt.<br>Lbs. | Thread<br>Diam.<br>Inches | Length<br>Overall<br>Inches | Price<br>Per<br>Piece | Pkg.<br>Qty. |
|--------------|------------------------|-------------|---------------------------|-----------------------------|-----------------------|--------------|
| <b>P7249</b> | 7/8 & 1-1/8            | 2           | 1                         | 8                           | <b>\$12.35</b>        | 4            |

### CATEGORY 1 & 2

### TRACTOR CATEGORY DEFINITIONS

(Per ASAE Standards)

|            | Tractor<br>Horsepower | Linkage Dimensions |              |
|------------|-----------------------|--------------------|--------------|
|            |                       | Top Link Pin       | Lift Arm Pin |
| Category 0 | Up to 20              | 5/8                | 5/8          |
| Category 1 | 20 to 45              | 3/4                | 7/8          |
| Category 2 | 40 to 100             | 1                  | 1-1/8        |
| Category 3 | 80 and over           | 1-1/4              | 1-7/16       |

Prices subject to change without notice. **ASK FOR QUANTITY DISCOUNT**

**1-800-228-9222 / e-mail: sales@baumhydraulics.com**  
Fax: 1-800-832-2522 / www.baumhydraulics.com / © Baum Hydraulics Corporation

**BAUM HYDRAULICS CORPORATION**

# TOP LINKS, PINS, CYLINDERS & DRAWBARS

## TOP LINKS -

| Speeco Part Number | For Pin Size Inches | For Ball Socket Size Inches | Category No. | Collapsed Length Inches | Extended Length Inches | Thread Size Inches | Price Per Piece |
|--------------------|---------------------|-----------------------------|--------------|-------------------------|------------------------|--------------------|-----------------|
| TL197              | 5/8                 | 5/8                         | 0            | 13                      | 18                     | 3/4                | \$32.86         |
| TL165P Hvy.*       | 3/4                 | 3/4                         | 1            | 21                      | 31                     | 1-1/8              | 34.14           |
| TL173P Hvy.        | 1                   | 1                           | 2            | 23                      | 32                     | 1-1/4              | 69.94           |
| TL174P             | 1                   | 1                           | 2            | 21                      | 31                     | 1-1/8              | 41.60           |
| TL175 Hvy.* +      | 1                   | 1                           | 2            | 23                      | 32                     | 1-1/4              | 97.55           |
| TL187 Hvy.         | 1-1/4               | 1-1/4                       | 3            | 25.5                    | 37                     | 1-3/8              | 160.86          |

\* With Thread Lock. + Ratchet Handle Only

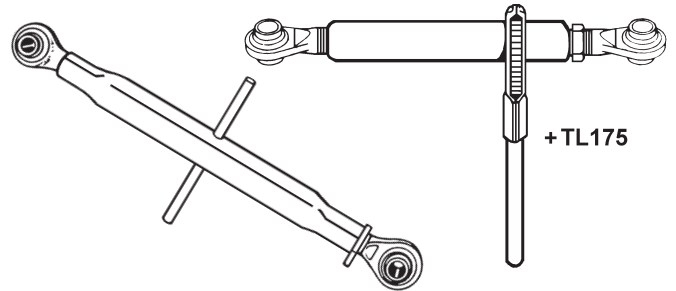

## TOP LINK REPAIR ENDS -

LH in Part Number indicates Left Hand Thread  
RH in Part Number indicates Right Hand Thread

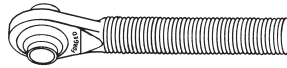

| Speeco Part Number | Pinhole Size Inches | Category No. | Type   | Fits  | Thread Size Inches | Price Per Piece |
|--------------------|---------------------|--------------|--------|-------|--------------------|-----------------|
| RE1619 LH          | 3/4                 | 1            | Forged | TL165 | 1-1/8              | \$20.81         |
| RE1620 RH          | 3/4                 | 1            | Forged | TL165 | 1-1/8              | 20.81           |
| RE1212 LH          | 1                   | 2            | Welded | TL127 | 1-1/4              | 39.53           |
| RE1717 LH          | 1                   | 2            | Forged | TL173 | 1-1/4              | 31.72           |
| RE1718 RH          | 1                   | 2            | Forged | TL173 | 1-1/4              | 31.72           |

## TOP LINK CYLINDER -

Category II Only,  
1" Swivel Pinhole, 1/2" NPT Ports



| Prince Weld-A-Cylinder Number | Size Inches Bore x Stroke | PSI  | Shaft Diam. Inches | Overall Length Retracted Inches | Price Per Piece |
|-------------------------------|---------------------------|------|--------------------|---------------------------------|-----------------|
| BD-0228                       | 3 x 10                    | 3000 | 1-3/8              | 20-7/8                          | \$412.15        |

## SPEECO RATCHET JACK WITH ACME THREAD -

8,000 Lb. Push / 15,000 Lb. Pull. Housing made of Steel Tubing & Yoke & Handle made of steel.  
Replace 8" Cylinders 1" Clevis pins & handle included.  
Replaces standard hydraulic cylinders & screw jacks.

| Part Number | Collapsed Length Inches | Extended Length Inches | Thd. Size Inches | Wt. Lbs. | Price Per Piece |
|-------------|-------------------------|------------------------|------------------|----------|-----------------|
| SL1541GL    | 20                      | 28                     | 1-1/4            | 14-1/4   | \$73.15         |

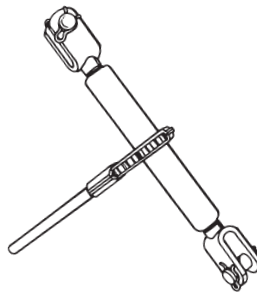

## POWER TAKE-OFF MILLER LOCK PINS -

| Part Number | Pin Diam. Inches | Head Diam. Inches | Useable Length Inches | Wt. Lbs. | Price Per Piece | Pkg. Qty. |
|-------------|------------------|-------------------|-----------------------|----------|-----------------|-----------|
| 516-22LP    | 5/16             | 5/8               | 2-5/8                 | 1/10     | \$1.36          | 4         |
| 38-20LP     | 3/8              | 5/8               | 2-1/4                 | 1/10     | 1.38            | 4         |

For 03-34-00037 use 516-22LP



## POWER TAKE-OFF MILLER LYNCH PINS -

| Part Number | Pin Diam. Inches | Head Diam. Inches | Useable Length Inches | Wt. Lbs. | Price Per Piece | Pkg. Qty. |
|-------------|------------------|-------------------|-----------------------|----------|-----------------|-----------|
| 38-13LP     | 3/8              | 5/8               | 1-1/2                 | 1/10     | \$1.24          | 4         |
| 14-16LP     | 1/4              | 1/2               | 1-3/4                 | 1/10     | 1.36            | 4         |



## DRAWBARS - All heat treated C1045 steel.



| Part Number  | Drawbar Size, Inches | Price Per Piece |
|--|----------------------|-----------------|
| 5/8" Pins and 20" Spacing with Seven 5/8" Holes DB418          | 5/8x2x20             | \$27.34         |
| 7/8" Pins and 26" Spacing with Eleven 3/4" Holes DB4115 Reg.   | 1-1/8x2-1/2x26       | 55.74           |
| 1-1/8" Pins and 26" Spacing with Eleven 3/4" Holes DB421 Reg.  | 1-1/4x3x26           | 61.45           |
| 1-7/16" Pins and 38" Spacing with Five 1-1/4" Holes DB431 Reg. | 1-3/4x3-1/2x38       | 182.65          |

## TOP LINK PINS -

Di-Chrome Plated



| Speeco Part Number | Pin Diam. | Length Overall Inches | Useable Length Inches | Price Per Piece |
|--------------------|-----------|-----------------------|-----------------------|-----------------|
| <b>Category 0</b>  |           |                       |                       |                 |
| P776               | 5/8       | 4-7/16                | 3                     | \$2.07          |
| <b>Category 1</b>  |           |                       |                       |                 |
| P771               | 3/4       | 4-1/2                 | 2-3/4                 | 2.12            |
| P772               | 3/4       | 5-1/2                 | 3-7/8                 | 2.45            |
| P7715              | 3/4       | 6-3/8                 | 4-3/4                 | 3.10            |
| <b>Category 2</b>  |           |                       |                       |                 |
| P7719              | 1         | 4-3/4                 | 3                     | 5.63            |
| TLP4250*           | 1         | 6                     | 4-1/4                 | 8.71            |
| P774               | 1         | 6                     | 4-3/8                 | 4.71            |
| P7720              | 1         | 7-1/16                | 5-3/8                 | 6.77            |
| <b>Category 3</b>  |           |                       |                       |                 |
| P7711              | 1-1/4     | 6-1/2                 | 4-5/8                 | 9.79            |

\*Miller

ASK FOR QUANTITY DISCOUNT Prices subject to change without notice.

# LYNCH PINS - KLIK PINS

C5

For Three Point Hitches - Full Lock Design.  
Fits any hole requiring a lynch pin.



**SPEECO LYNCH PINS** - Di-chromate plated. Forged Pin complete with snap lock ring. 7/16 x 11/32 pins have one flat side.  
Pkg. Qty. = 4 Pieces

| WITHOUT CHAIN   |                 | WITH CHAIN             |                 | A                | B                        | C                       | D                         |
|---|-----------------|------------------------|-----------------|------------------|--------------------------|-------------------------|---------------------------|
| Without Chain Part Number   | Price Per Piece | With Chain Part Number | Price Per Piece | Pin Diam. Inches | Inside Ring Diam. Inches | Shank Length Pin Inches | Overall Length Pin Inches |
| <b>Standard Long-Shank Pin-Ring Will Not Fit Over End of Pin</b>              |                 |                        |                 |                  |                          |                         |                           |
| P791  | \$0.44          | P792                   | \$1.80          | 7/16             | 1-1/4                    | 1-3/4                   | 2-1/8                     |
| <b>Black Ring Heavy Duty Long-Shank Pin-Ring Will Not Fit Over End of Pin</b> |                 |                        |                 |                  |                          |                         |                           |
| P7913   | 0.98            | P7914                  | ....            | 7/16             | 1-1/2                    | 1-3/4                   | 2-3/16                    |
| <b>Safety Lock Long-Shank Pin-Ring Will Not Fit Over End of Pin</b>           |                 |                        |                 |                  |                          |                         |                           |
| ---   | ....            | ---                    | ....            | 7/16             | --                       | 2                       | 2-7/16                    |
| <b>Short Shank Pin-Ring Will Not Fit Over End of Pin</b>                      |                 |                        |                 |                  |                          |                         |                           |
| P795  | 0.87            | P796                   | 1.90            | 7/16             | 1-1/4                    | 1-3/8                   | 1-3/4                     |
| <b>Long Shank Pin-Ring Will Not Fit Over End of Pin</b>                       |                 |                        |                 |                  |                          |                         |                           |
| P794  | 0.44            | ---                    | ....            | 1/4              | 1-1/4                    | 1-3/4                   | 2-1/8                     |
| P7916   | 1.01            | ---                    | ....            | 3/8              | 1-1/4                    | 1-3/4                   | 2-1/8                     |

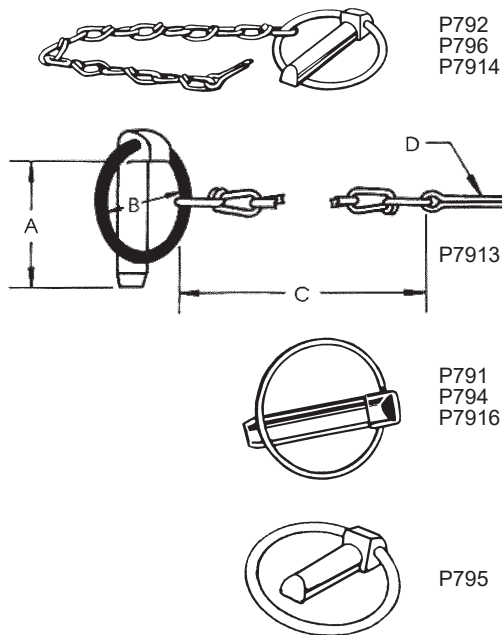

## DANUSER®

**DANUSER KLIK PINS** - Di-chromate plated. Forged Pin complete with snap lock ring. 7/16 x 11/32 pins have one flat side.  
Pkg. Qty. = 4 Pieces

| WITHOUT CHAIN   |                 | WITH CHAIN             |                 | A                | B                        | C                       | D                         |
|---|-----------------|------------------------|-----------------|------------------|--------------------------|-------------------------|---------------------------|
| Without Chain Part Number   | Price Per Piece | With Chain Part Number | Price Per Piece | Pin Diam. Inches | Inside Ring Diam. Inches | Shank Length Pin Inches | Overall Length Pin Inches |
| <b>Standard Long-Shank Pin-Ring Will Not Fit Over End of Pin</b>              |                 |                        |                 |                  |                          |                         |                           |
| 7524  | \$2.47          | 7525                   | \$....          | 7/16             | 1-7/8                    | 2                       | 2-7/16                    |
| 1533  | 2.27            | ---                    | ....            | 7/16             | 1-3/8                    | 1-3/4                   | 2-3/16                    |
| <b>Black Ring Heavy Duty Long-Shank Pin-Ring Will Not Fit Over End of Pin</b> |                 |                        |                 |                  |                          |                         |                           |
| 7631  | ....            | 7634                   | ....            | 7/16             | 1-3/8                    | 1-3/4                   | 2-3/16                    |
| 7862  | 2.82            | ---                    | ....            | 7/16             | 1-5/8                    | 2                       | 2-7/16                    |
| <b>Safety Lock Long-Shank Pin-Ring Will Not Fit Over End of Pin</b>           |                 |                        |                 |                  |                          |                         |                           |
| 9656  | 3.22            | 9655                   | ....            | 7/16             | 1-3/4                    | 2                       | 2-7/16                    |
| <b>Short Shank Pin-Ring Will Not Fit Over End of Pin</b>                      |                 |                        |                 |                  |                          |                         |                           |
| ---   | ....            | ---                    | ....            | 7/16             | --                       | 1-3/8                   | 1-3/4                     |
| <b>Long Shank Pin-Ring Will Not Fit Over End of Pin</b>                       |                 |                        |                 |                  |                          |                         |                           |
| 7637  | 0.93            | ---                    | ....            | 3/16             | 1                        | 1-1/4                   | 1-35/64                   |
| 1600  | 0.96            | 1601                   | 2.07            | 1/4              | 1-3/8                    | 1-3/4                   | 2-9/64                    |
| 7618  | 1.22            | 7619                   | ....            | 5/16             | 1-5/8                    | 2-11/32                 | 2-47/64                   |

### Picture With Chain Without Chain

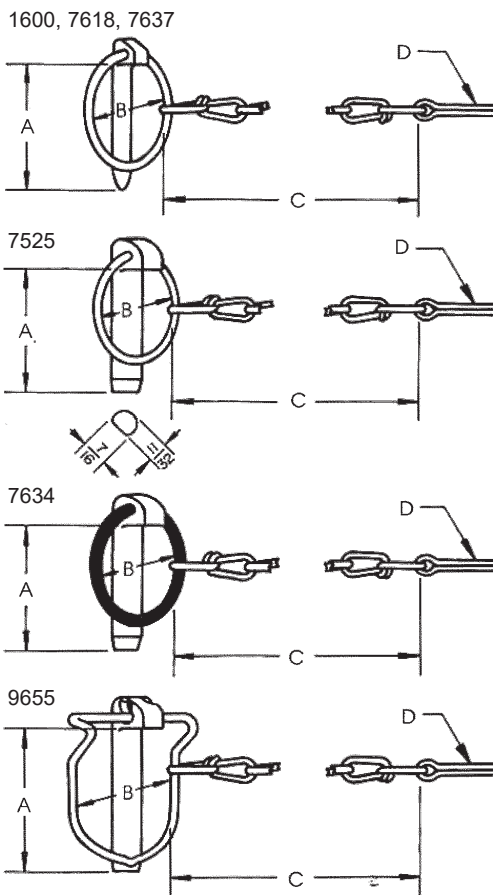

Prices subject to change without notice. **ASK FOR QUANTITY DISCOUNT**

1-800-228-9222 / e-mail: sales@baumhydraulics.com  
Fax: 1-800-832-2522 / www.baumhydraulics.com / © Baum Hydraulics Corporation

**BAUM** HYDRAULICS CORPORATION